

# 80 Series Front Indicator/DRL

**ECE**  
Approved

**IP67**  
Protection

**5 Year**  
Warranty

- Retro fit to existing 4x4 bullbar
- ECE Australian Road Approved
- Fully submersible
- 5 Year Warranty

**Function** Front Indicator Front Marker Daytime Running use  
Part No. \*DRLHOTDOG

**Size** 80mm Round x 40mm

**Voltage** Voltage Specific 12 Volt or 24 Volt

**LED Qty** 34

**Cable** 340mm cable

**Draw**      **Ind**    **DRL**    **Marker**  
@13.8V    0.32A   TBA    0.03A

Approvals	Function	Approval
ECE	Front Indicator	1-E9-01.11725
ECE	Marker	A-E9-02.11725
ECE	DRL	RL-E9-00.11725
CTA	Indicator/Marker/DRL	CTA-060217



P/N 80AW - 12 Volt, Blister  
P/N 80AW24 - 24 Volt, Blister  
P/N 80AWB - 12 Volt, Box

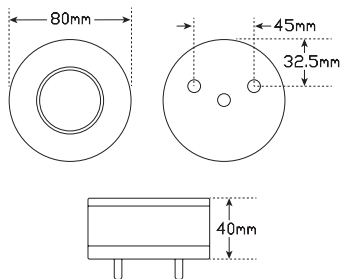

\*DRLHOTDOG



## Fitting Instructions

Fit to existing bullbar applications. Please refer to ADR 13/00 for mounting instructions.



All enquiries P: (03) 9466 7075 E: led@ledtech.com.au, www.ledautolamps.com

All efforts are made to ensure all information is correct and up to date, it can be subject to change without notice. All measurements are in millimeters (mm) and are not to scale.

© All LED Technologies designs are registered throughout the world. - Current as of 17/12/2021